

Project:

## Planes LED Sconce Spec Sheet

SKU: 2680.16    Learn more at:  
<https://sonnemanlight.com/planes-led-sconce>

Description: Pristine in its geometric simplicity, precisely framed minimal profiles capture technologically advanced edge-lit light panels, producing a high level of efficient LED illumination. Available in single and double versions, Double Planes can be mounted in vertical or horizontal orientations. Also available as a [Double Sconce](#) and [Pendant](#).

Type #:

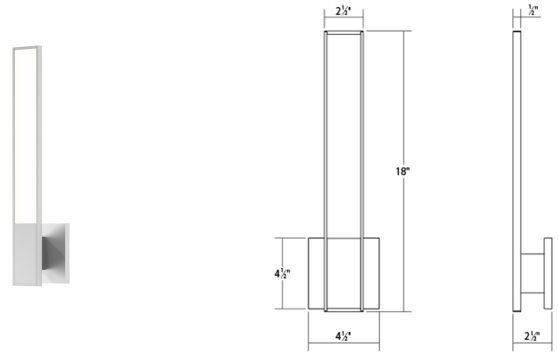

### Dimensions

|                               |      |
|-------------------------------|------|
| Height:                       | 18"  |
| Width:                        | 2.5" |
| Extends:                      | 2.5" |
| Minimum Extension:            | 2.5" |
| Maximum Extension:            | 2.5" |
| Canopy/Backplate/Base Width:  | 4.5  |
| Canopy/Backplate/Base Depth:  | 0.5  |
| Canopy/Backplate/Base Height: | 4.5  |

### Electrical Specs

|                        |              |
|------------------------|--------------|
| Bulb(s) Included?:     | Yes          |
| Bulb 1 Type:           | Integral LED |
| Bulb Quantity:         | 1            |
| Input Voltage:         | 120VAC       |
| Wattage:               | 6            |
| Initial Lumens:        | 700          |
| Delivered Lumens:      | 250          |
| Color Temperature:     | 3000K        |
| CRI:                   | 90           |
| Power Supply Type:     | Driver       |
| Power Supply Quantity: | 1            |
| Power Supply Location: | Outlet Box   |
| Dimming Type:          | TRIAC/ELV    |
| Bulb Max Wattage:      | 6            |

### Installation

|                           |                               |
|---------------------------|-------------------------------|
| Installation:             | Licensed electrician required |
| Installation Orientation: | Vertical                      |

### Shipping

|                        |               |
|------------------------|---------------|
| Carton 1 L x W x H:    | 21" X 7" X 8" |
| Carton 1 Gross Weight: | 3 LBS         |

### Shade

|                   |                           |
|-------------------|---------------------------|
| Shade 1 Material: | Aluminum w/LED Flat Panel |
|-------------------|---------------------------|

### Available Finishes

Available Finishes: Bright Satin Aluminum (.16), Satin Black (.25), Satin White (.03)

### General Listings

|                    |                             |
|--------------------|-----------------------------|
| Features:          | Damp Rated                  |
| Certification:     | cETL                        |
| Color/Finish:      | Bright Satin Aluminum (.16) |
| Dark Sky Friendly: | N                           |