

Part Num.	Item Description	UPC# 046224 +	Ctn Qty	Ctn Wt	Line Art
-----------	------------------	---------------	---------	--------	----------

SPECIFICATION DRAWINGS ~ COMMERCIAL ITEMS

Catalog No.	Dimensions				
	A	B	C	D	E
5700PC	2 ³ / ₁₆ "	1 ⁷ / ₁₆ "	1"	7 ³ / ₄ "	5"

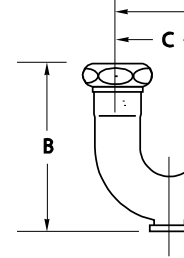
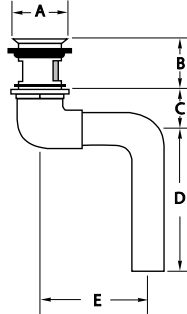
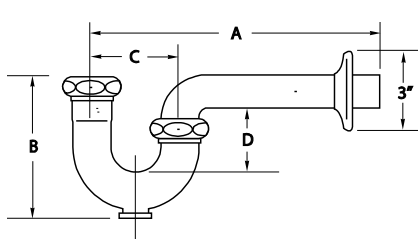

Catalog No.	Dimensions			
	A	B	C	D
5303	11"	5 ¹ / ₈ "	2 ¹ / ₂ "	1 ³ / ₄ "
5307-5311	12"	5 ¹ / ₄ "	2 ⁷ / ₈ "	2 ¹ / ₈ "

Catalog No.	Dimensions			
	A	B	C	D
5680PC	2 ³ / ₁₆ "	1 ¹ / ₂ "	4"	6 ³ / ₄ "
5682PC	2 ³ / ₁₆ "	1 ¹ / ₂ "	5 ³ / ₄ "	8 ¹ / ₄ "

- THE "COMMERCIAL LINE" MEANS QUALITY FOR PLUMBING PROFESSIONALS



- SEMI CAST PRODUCTS
- LOOSE KEY STOPS

COMMERCIAL LINE

CROSS REFERENCE

KEENEY CAT. NO.	Am. Std. Cat. No.	Crane Cat. No.	Eljer Cat. No.	Kohler Cat. No.	Mc Guire Cat. No.
5303PC	4401.014	8-5260	804-1180	K-8998	8872
5311PC	4402.012	8-5260	804-1185	K-8999	8902
5307PC	4403.010	8-5260	804-1190	K-9000	8912
5459XPC	4418.026	8-5272	804-1100	K-9004	8088
5463XPC	4420.030	8-5272	804-1105	K-8995	8090
5461XPC	4419.040	8-5272	804-1110	K-8996	8089
384PC	4429.015	8-5270	804-1125	K-9010	201
385PC	4430.013	8-5270	804-1130	K-9010	202
5680PC	2411.015	8-5222	803-0552	K-7715	155-A
5700PC	7723.018		803-0530	K-13885	155-WC

SEMI-CAST TRAPS WITH CLEANOUT - BRASS NUTS

5303PC	1 1/4" X 1 1/4" 17GA POLISHED CHROME		93263 5	25	38 lbs.
5311PC	1 1/4" X 1 1/2" 17GA POLISHED CHROME		93274 1	25	59 lbs.
5307PC	1 1/2" X 1 1/2" 17GA POLISHED CHROME		93272 7	25	58 lbs.

