

CRYSTORAMA

LIGHTING THE WAY FOR SIXTY YEARS



Crystorama.com

ASSEMBLY INSTRUCTION MODEL #ORS-733-MG-ST

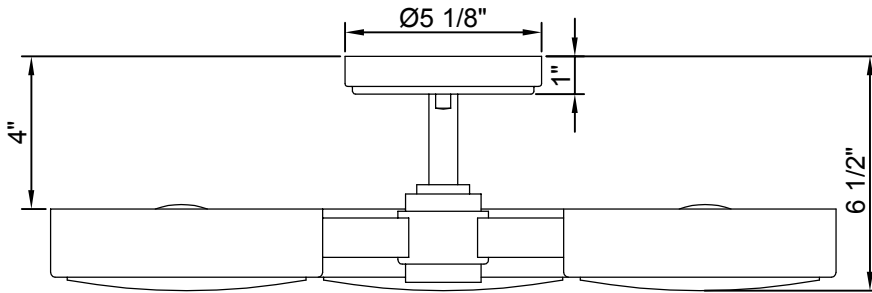

WARNING:



Electrical Danger

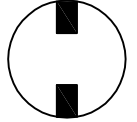

Turn Power Off

All electrical components must be installed by a licensed electrician in accordance with the National Electric Code and the appropriate local electrical codes.

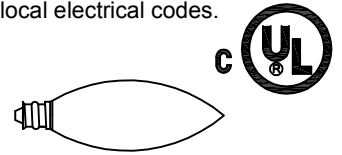

You will need 3 - Candelabra Bulb
40 Watts Recommended 60 Watts Max.
USE LED BULBS FOR EXTENDED USE
This fixture is Dry Rated.

How to Install

1. Attach mounting plate to the outlet box using box screws.
2. Connect the fixture wires to the supply wires.
3. Mount the fixture to the outlet box with ball nuts.
4. Place stone into the frame.
5. Install the bulb (Not included) in accordance with the fixture's specifications. (DO NOT EXCEED THE MAXIMUM WATTAGE RATING!)

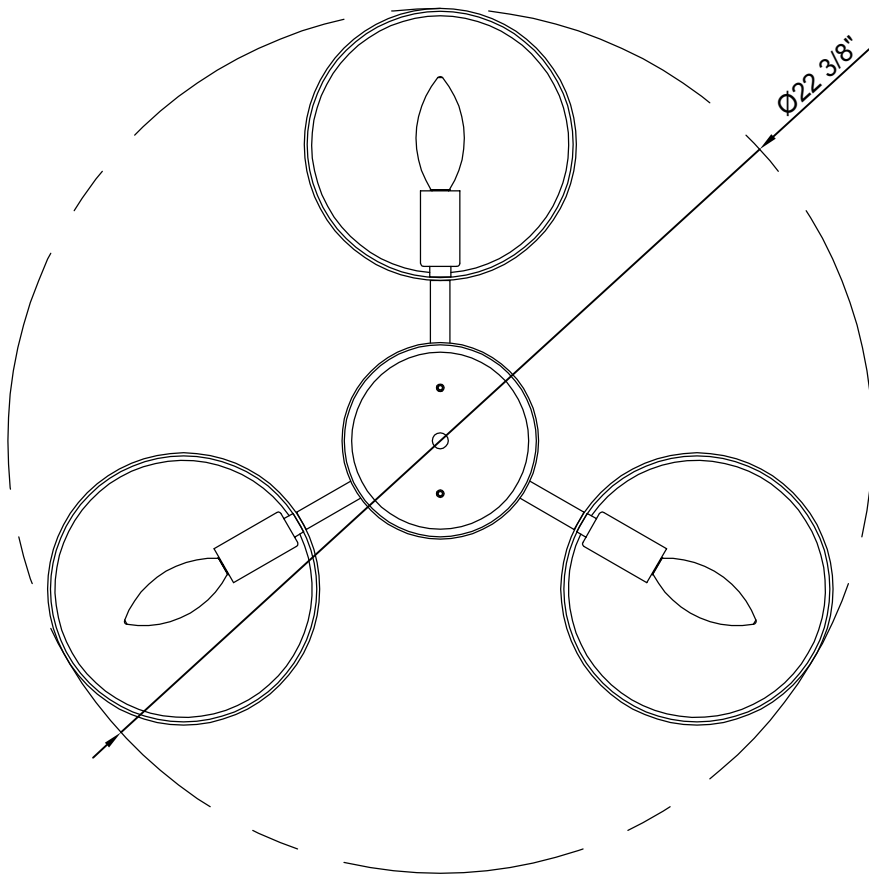

CRYSTORAMA

LIGHTING THE WAY FOR SIXTY YEARS



Crystorama.com

PART NUMBER MODEL #ORS-733-MG-ST

Part Number

Part Numbers

- A. Mounting Hardware
 - (3) - Wire connector
 - (1) - Mounting Plate
 - (2) - Box Screws
 - (1) - Grounding Screw
- B. (2) - Ball Nut; XVE733MGBANUT
- C. (3) - Stone; $\text{Ø}6\text{-}3/4"$ x H1/2"; XVE733STONE
- D. (1) - Canopy; $\text{Ø}5\text{-}1/8"$ x H1"; XVE733MGCAN5.125IN

