

Model No :: **62515LEDD-BS/ACR**
 Name :: Summit



Project Name :: _____
 Location :: _____
 Type :: _____
 Quantity :: _____
 Notes :: _____

Product Information

Product ID :: 62515
 UPC Code :: 641594229325
 Mounting Type :: Wall
 Finish :: Brushed Steel (BS)
 Diffuser :: Acrylic Lens (ACR)
 Alt. Finishes :: Brushed Steel (BS)
 Alt. Diffusers :: Acrylic Lens (ACR)

Product Dimensions

Fixture	Canopy
Length :: N/A	Length :: 0.75"
Width :: 36"	Width :: 6.25"
Diameter :: N/A	Diameter :: N/A
Extension :: 3.5"	Height :: 4.5"
Height :: 4.5"	
Overall Height :: N/A	



Technical Specifications

Qualifications	Specifications	Photometrics	Recommended Dimmers
Location Rating :: Damp	Frame Material :: Metal	CCT :: 3000	(ELV) LUTRON Caseta PD - 6WCL; (ELV) LUTRON Maestro CL MACL-153M; (ELV) LUTRON Maestro MRF2-6CL; (TRIAC) LUTRON Diva DVCL-153P
Certification :: ETL Listed (US/Canada)	Diffuser Material:: Acrylic	CRI :: 90	
IES File ::	Voltage :: 120v	Wattage :: 30w	
JA8 Compliant :: Yes	Lamping Type :: Dedicated LED	Nominal Lumens :: 2800Lm	
Energy Star :: No	Lamping Base :: SSL	Delivered Lumens :: 2209Lm	
ADA Compliant :: Yes	Lamp Quantity :: 1	Additional Items :: 0	
Marine Grade :: No	Lamp Wattage :: 30 W		
Emergency Lighting :: No	Total Wattage :: 30w		
Warranty :: 5 Year Limited	Lamps Included :: Yes		
	J-Box Type :: Standard		

Line Drawing #1

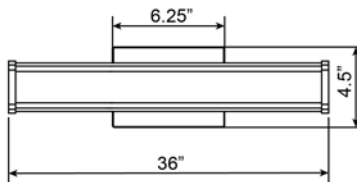

Line Drawing #2

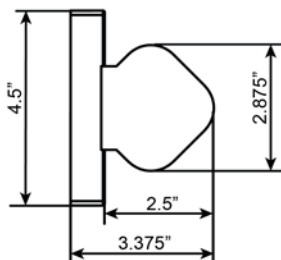

IES File

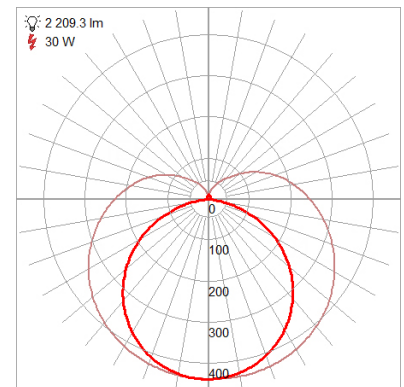

Toll Free 800-828-5483 • www.AccessLighting.com

14410 Myford Road, Irvine, CA 92606

The information provided is subject to change without notice. ©2020 Access Lighting Corporation. All Rights Reserved
 Rev. 202004 Filename:: 62515LEDD-BS_ACR.pdf

